

Installation Guide

LED Linear Luminaire

5
YEARS WARRANTY*

BEFORE YOU BEGIN

Read these instructions completely and carefully, and save it for future reference. Use only in the manner intended by the manufacturer. If you have any questions, contact the manufacturer.

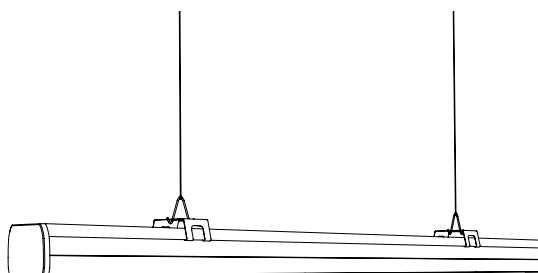

WARNING

RISK OF ELECTRIC SHOCK

- Turn power off before inspection, installation or removal.
- Properly ground electrical enclosure.

RISK OF FIRE

- Follow all NEC and local codes.
- Use only UL or IEC approved wire for input/output connections. Minimum size 18 AWG.

Prepare Electrical Wiring

Electrical Requirements

- The LED driver must be supplied with 90-277VAC, 50/60 Hz per product label and connected to an individual properly grounded branch circuit, protected by a 15 or 20 ampere circuit breaker.

Grounding Instructions

- The grounding and bonding of the overall system shall be done in accordance with National Electric Code (NEC) Article 600 and local codes.

UNIT INSTALLATION

- 1 Carefully unpack unit and properly inspect for defects before installing. Wear work gloves to prevent dirt and oil from being transferred to the luminaire.
- 2 Please follow all UL, NEC and minimum load rating guidelines when selecting and installing a chain, cable or rod.
- 3 Hang up to two chains, cables or rods from a structural member of the ceiling to support each fixture. Fixture must be supported independently of an outlet box. Install mounting brackets for each fixture.

LET'S START TO INSTALL

Note: Please see additional wiring instructions if installing multiple fixtures in a Continuous Run or an inline Control Module.

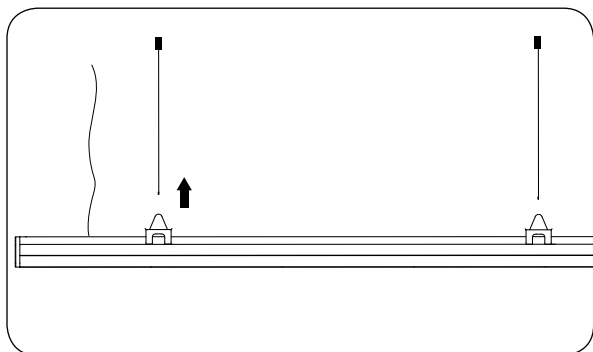

- 1 Take out the lamp from the packaging, install two hooks.

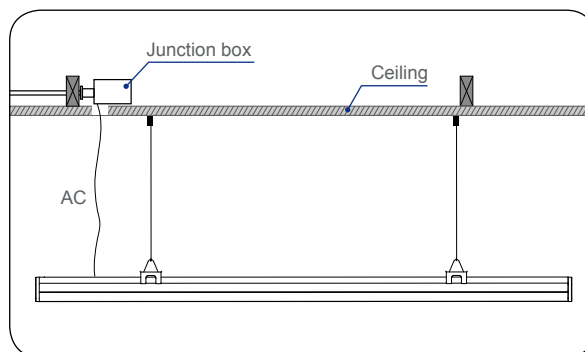

- 2 Find a suit hanging position, hang up the lamps, plug in then complete the installation;

Continuous Run Installation

When ordered as an option, continuous run fixtures use end connector plate to properly wire & align the joining fixtures.

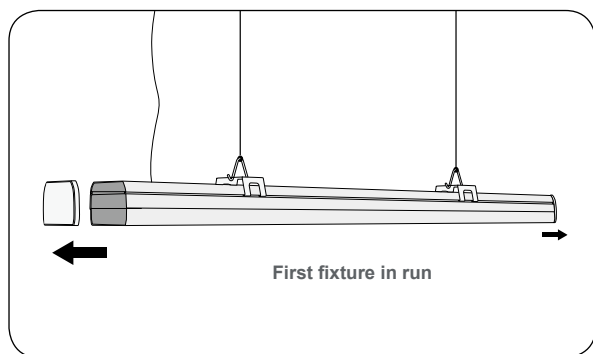

- 1 Turn off the power, and take off the end caps at both sides.

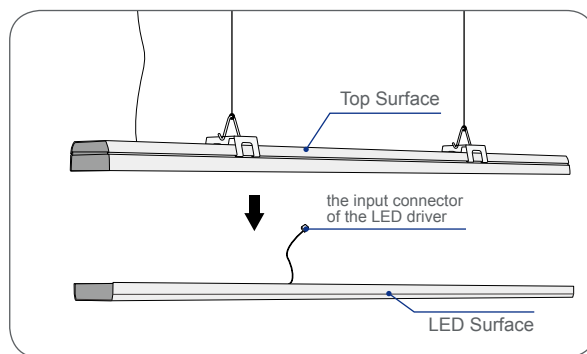

- 2 Split the LED surface and the top surface, then take off the input connector of the LED driver.

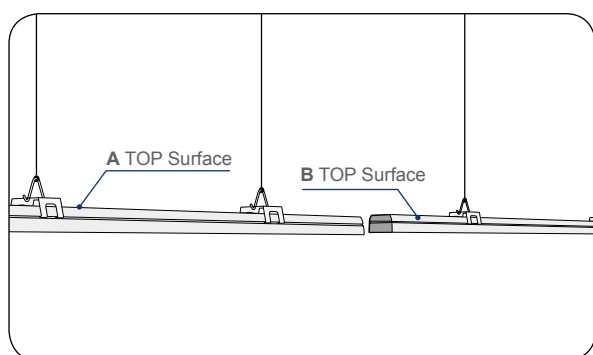

- 3 Take off the end caps at each side of the new fixture, follow the step2, split it's LED surface and top surface, completely up the top surface of the new fixture, adjust the position, making sure the two fixture line closely.

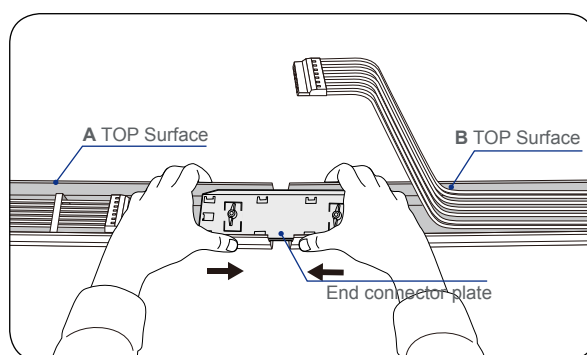

- 4 Screw the end connector plate with the A top surface and B top surface tightly.

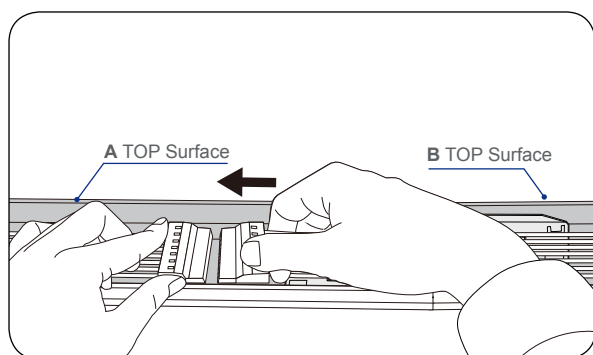

- 5 Connect to the AC cable.

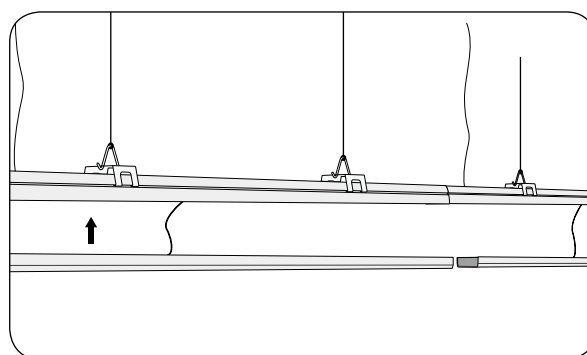

- 6 Raise the LED surface to a proper high, connect AC input wires with the LED driver, install the LED surface back together with the top surface in the help of other people, install the end caps at each side, interconnection works.

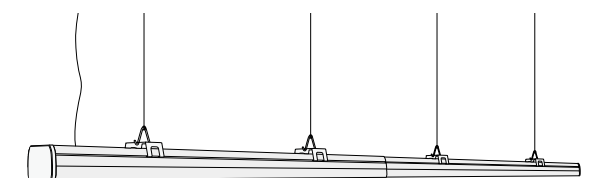

- 7 Continue to add fixtures as needed to complete the continuous run.

Troubleshooting

Symptom	Solution
Luminaire will not turn on.	<ul style="list-style-type: none">• Check that the color of the supply side wires match the color of the wires they are connected to.• Check that all wire connectors are properly connected.• Verify that your input voltage is within specs.• If you are using any additional controls IE wireless controls // motion sensors, please also verify that those are working properly and that the unit is setup to interface with the controllers.
Mounting bracket slides from side to side.	<ul style="list-style-type: none">• Check that the mounting bracket is properly tightened using the adjustment screws provided.

Care & Cleaning

CAUTION: Before attempting to clean the fixture, disconnect the power to the fixture by turning the breaker off or removing the fuse from the fuse box.

Your fixture is made from quality materials that will last many years with minimum care. You may want to periodically clean the diffuser, or interior of the fixture using a mild, non-abrasive glass cleaner and a soft cloth.

DO NOT use solvents, or cleaners containing abrasive agents. When cleaning the inside of the fixture, make sure you have the power turned off, and do not spray liquid cleaner directly onto the LEDs, LED driver or wiring.